

Foldable Dimmable LED Grow Light

Product Description

Eagle Star Lighting Foldable Dimmable LED Grow Light series are full spectrum grow lamp fixtures with Samsung +Red Light. They can provide more than 60% higher in PPFD compared with HID lamps with lower temperature, which increases the production and saves more than 50% power consumption. The fixtures can be used in many applications such as cannabis cultivation, vegetables, greenhouse, ornamental plants and so on. The slim design fixture that is foldable up to 180 degrees, making it small, compact, and easy to install.



- Fold driver
- Samsung LM301B+Red Light
- Full Spectrum red+white+660nm+730nm
- Input voltage 100-277VAC 50Hz/60Hz
- Ideal Working time: 10-14hours;
- Big&wide aluminum body with great heat dissipation
- The fixture can be connected one by one
- 0-10V dimming available
- Easy installation and maintenance
- Biggest Footprint: 4 ft*4 ft. Suitable for at least 2-4 plants;
- Certificate: CE RoHS ETL cETL

Product Parameters

Model	ES-GL660A01-YY	ES-GL720A01-YY
Rated Power	660W	720W
LED Chips	Samsung LM301B+Red Light	
Bars Qty	6 pieces	8 pieces
PPF	1782 $\mu\text{mol/s}$	1944 $\mu\text{mol/s}$
Efficacy	2.8-3.0 $\mu\text{mol/J}$	2.8-3.0 $\mu\text{mol/J}$
Input Voltage	100-277VAC 50Hz/60Hz	
Color Ratio	Full Spectrum red+white+660nm+730nm	
Working Environment	-20°C~+40°C 45%~95%RH	
Certifications	CE, RoHS, ETL, cETL	
Product Size	1120*1067*70mm	1180*1140*70mm
G.W	14kg(30.1Lbs)	15kg(33Lbs)
Carton Size	120*18*65cm	126*68*18cm
Replacement	1000W MH	1500W MH
Warranty	5 years	

Product Size

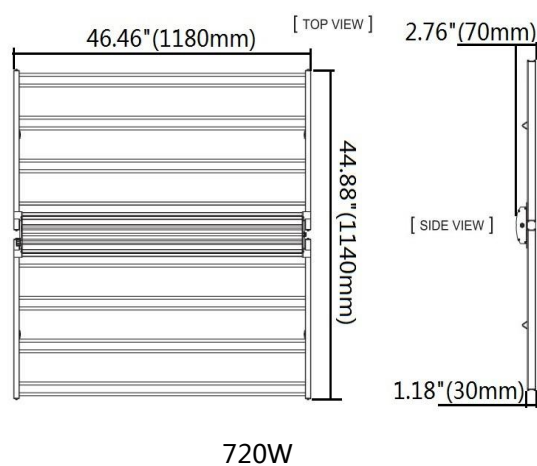
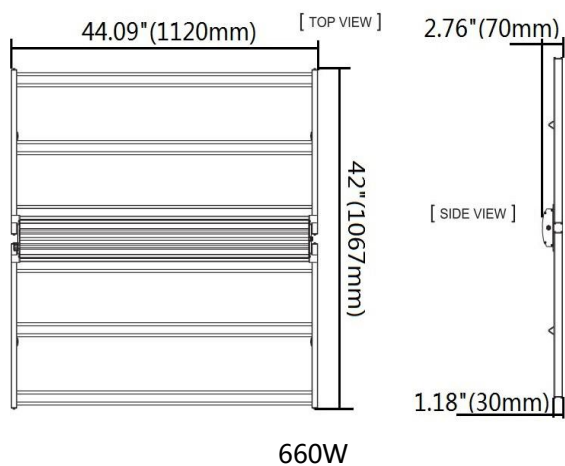

PPFD($\mu\text{mol}/\text{m}^2/\text{s}$)

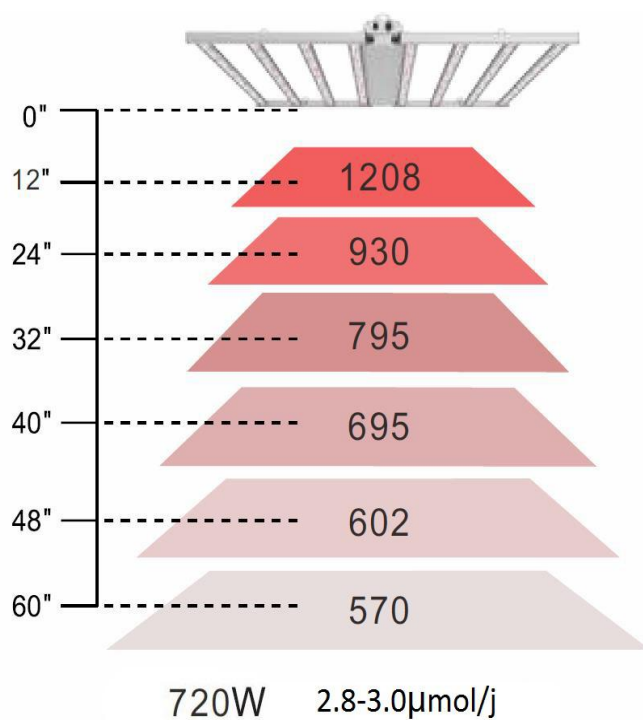
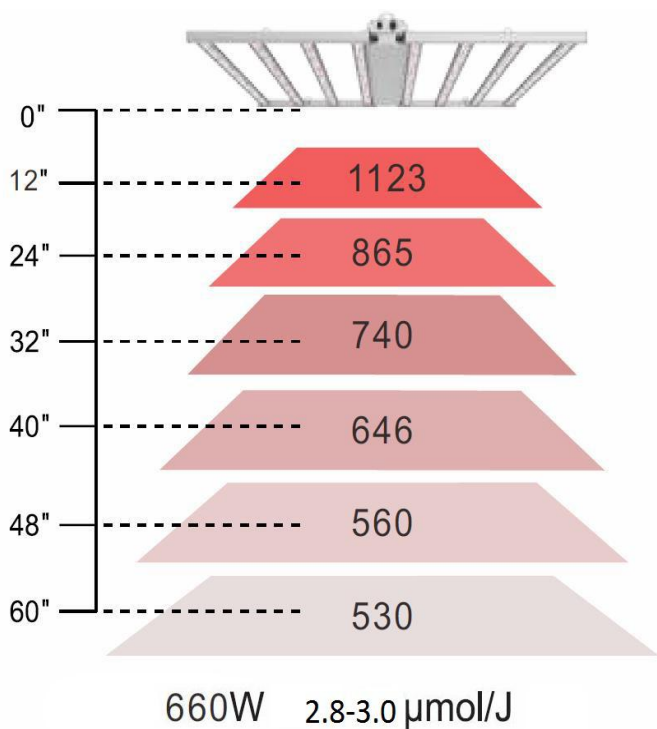

Spectrum

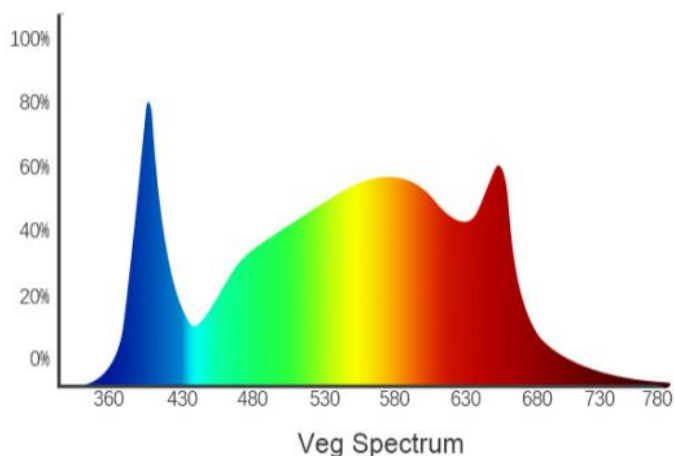
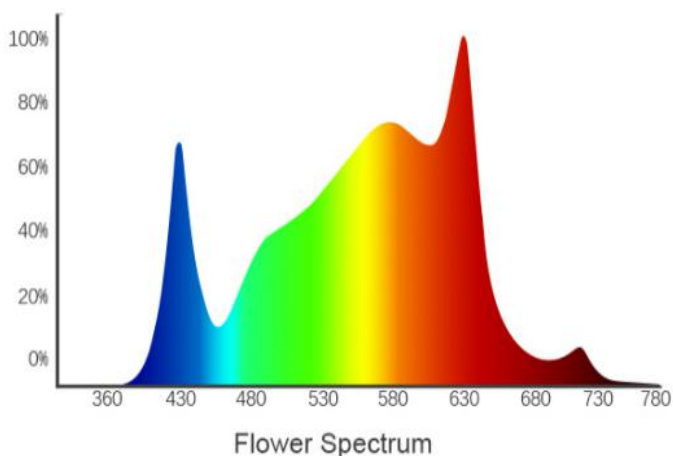

PPFD Distribution

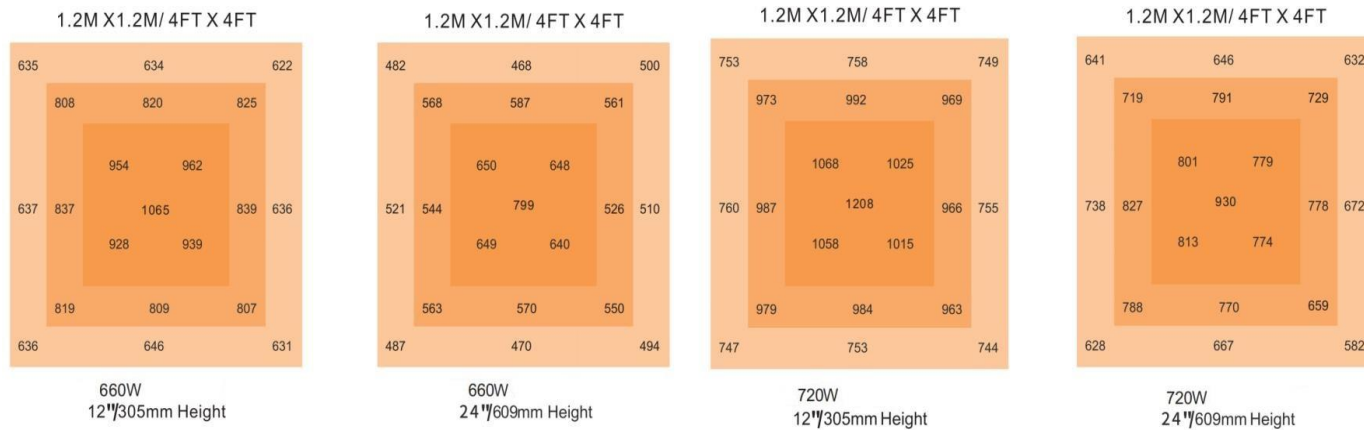

Installation

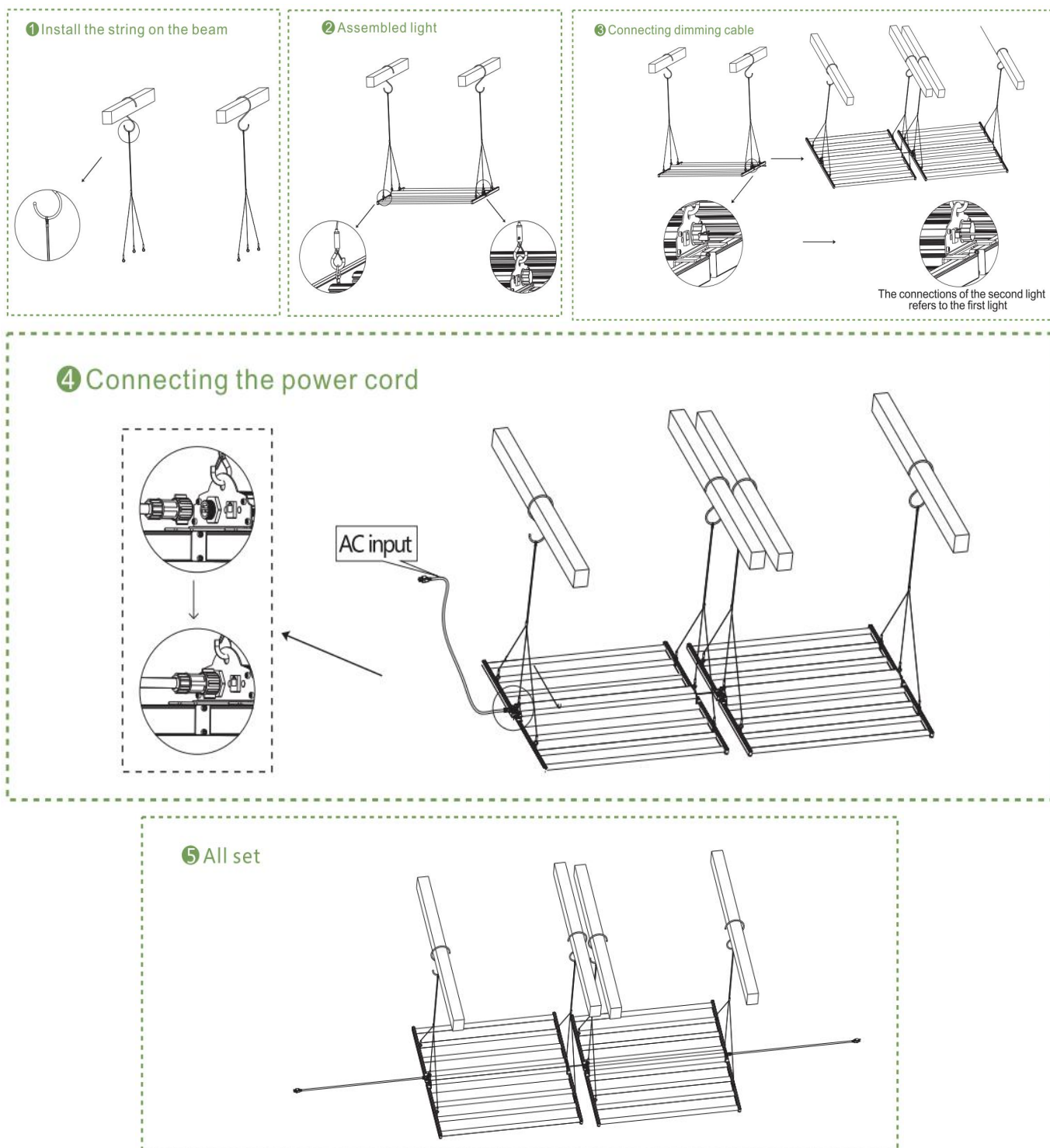

Applications

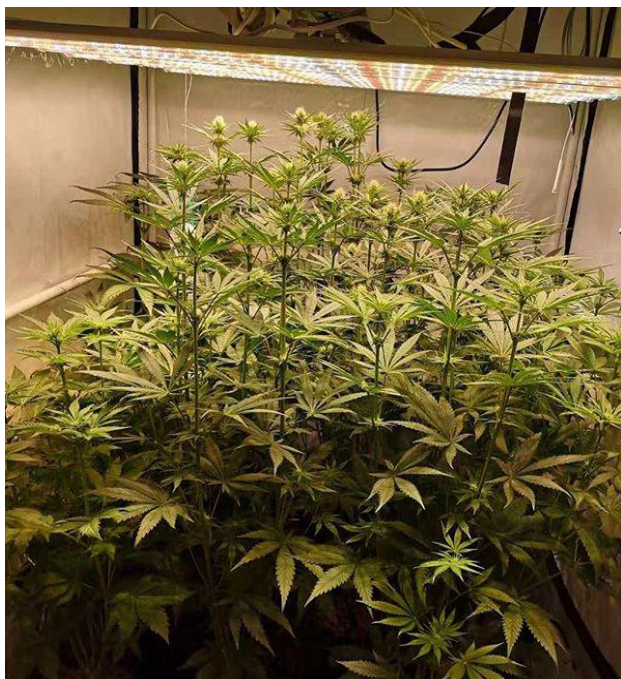

USA, Michigan, 12000 Square Meter, 1259 pcs light



Canada, Montréal, 3000 Square Meter, 429 pcs lights



UK, London, 6000 Square Meter, 665 pcs Lights



New Zealand, Wellington, 5000 Square Meter, 880 pcs light